



Oodle® Stool

MODEL#: OODLE31, OODLE33



OVERVIEW

Students come in all shapes and sizes, in the design of oodle, we considered every body type. With 17" of seating surface, larger students will feel just as welcome using an oodle. The unique base design incorporates a structural disc, which when flipped 180° provides the student with the ability to wiggle.

MATERIALS

The rocker BASE (structural disc) features a modest 10° of motion when engaged. With such an active seat, we designed oodle's edge to catch a student before he or she is able to lose their balance. And, of course, motion is optional on oodle, simply flip the rocker base back to flat to eliminate motion.

To stack oodle or sit flat, turn the movement disc over to the flat side and lock in place.

The oodle model "OODLE31" is sold with (3) three 6.5" high sections and (1) one rocker base. (additional rocker bases sold separately, Model "OODLEBASE CGR").

The oodle model "OODLE33" is sold with (3) three 6.5" sections and (3) three rocker bases. This setup allows each 6.5" section to be it's own 6.5" oodle.

OODLE COLOR OPTIONS



(Oodle stools are ordered in 1 color, to mix and match colors, order multiple oodle's in alternating color schemes)



DIMENSIONS

Model	Description	D"	W"	H"	F.C.	WT
OODLE31	Stack of Three with w/One Movement Disk	17	6.5 - 19.5	125		19.5 lbs
OODLE33	Stack of Three with w/three Movement Disk	17	6.5 - 19.5	125		25.5 lbs
OODLEBASECGR	Movement Disc Only*	17	1	70		3 lbs
OODLEFELT	Adhesive Felt Pad for Hard Floor Surfaces*		16 diameter	70		.02 lbs

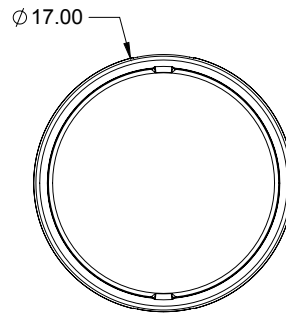

OPTIONAL ACCESSORIES:

OODLEBASECGR
Additional rocker
Base sold separately
Charcoal only

OODLEFELT
Optional felt pad for
use on hard flooring
(including VCT)

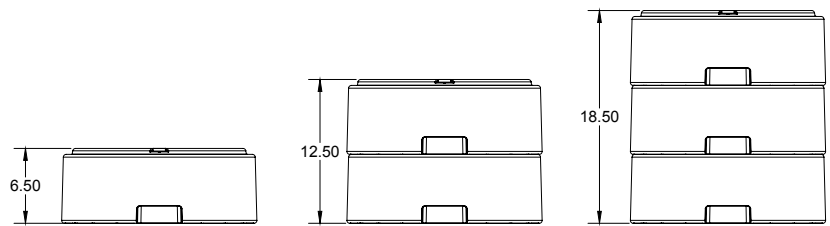

HEIGHT WITH ROCKER BASE DISENGAGED

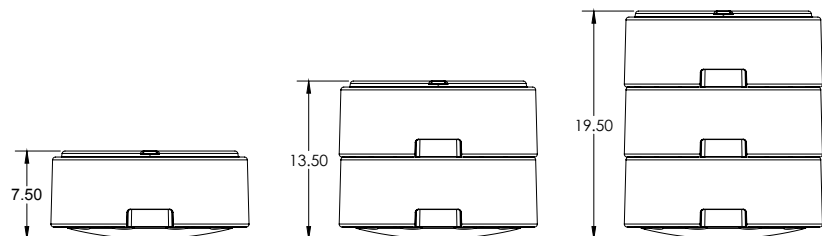

HEIGHT WITH ROCKER BASE ENGAGED
(10° MOTION)